

\$224,000 - 2551 135 Avenue, Edmonton

MLS® #E4455980

\$224,000

3 Bedroom, 2.00 Bathroom, 979 sqft

Condo / Townhouse on 0.00 Acres

Kernohan, Edmonton, AB

UPGRADED 3 BEDROOM, 2 FULL BATH townhome in a well-managed complex with LOW CONDO FEES! This fully finished home features a bright SOUTH-FACING FENCED YARD BACKING ONTO A PARK. Recent updates include a modern kitchen, 2 updated baths, upgraded flooring (laminated, carpet, tile & plank vinyl), newer paint, lighting, interior doors, casings, baseboards, furnace and STAINLESS STEEL appliances. The complex updates include newer vinyl siding, windows and exterior doors. The main level offers a spacious eat-in kitchen and large living room, while the upper floor provides 3 bedrooms and a 4-pce bath. The finished basement includes a generous family room, 3-pce bath, laundry and storage. One assigned parking stall is included, with extra stalls available at very low rates. Ideally located close to the River Valley trail system, Hermitage dog park, stocked ponds, outdoor skating, sports complexes, schools, shopping and public transportation. Quick access to the Yellowhead and Anthony Henday ensures easy commuting!

Built in 1977

Essential Information

MLS® # E4455980

Price \$224,000

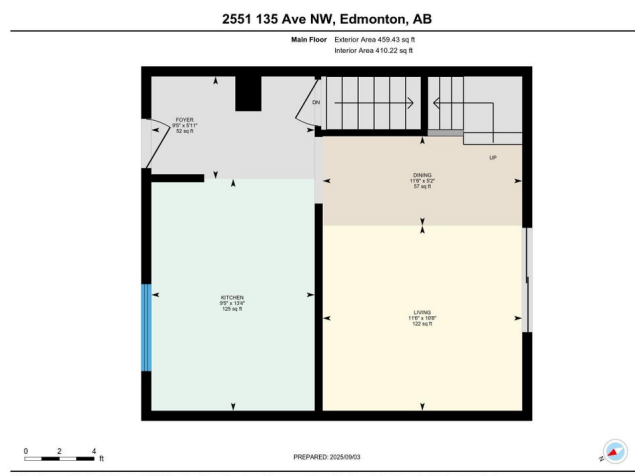

Bedrooms	3
Bathrooms	2.00
Full Baths	2
Square Footage	979
Acres	0.00
Year Built	1977
Type	Condo / Townhouse
Sub-Type	Townhouse
Style	2 Storey
Status	Active

Community Information

Address	2551 135 Avenue
Area	Edmonton
Subdivision	Kernohan
City	Edmonton
County	ALBERTA
Province	AB
Postal Code	T5A 3S5

Amenities

Amenities	Off Street Parking, On Street Parking, Closet Organizers, Patio, Vinyl Windows
Parking Spaces	1
Parking	Stall

Interior

Appliances	Dryer, Microwave Hood Fan, Refrigerator, Stove-Electric, Washer
Heating	Forced Air-1, Natural Gas
Stories	3
Has Basement	Yes
Basement	Full, Finished

Exterior

Exterior	Wood, Vinyl
Exterior Features	Backs Onto Park/Trees, Fenced, Landscaped, Park/Reserve, Playground Nearby, Public Transportation, Schools, Shopping Nearby
Roof	Asphalt Shingles
Construction	Wood, Vinyl

Foundation Concrete Perimeter

Additional Information

Date Listed September 4th, 2025
Days on Market 2
Zoning Zone 35
Condo Fee \$225

DATA IS DEEMED RELIABLE BUT IS NOT GUARANTEED ACCURATE BY THE REALTORS® ASSOCIATION OF EDMONTON. COPYRIGHT 2025 BY THE REALTORS® ASSOCIATION OF EDMONTON. ALL RIGHTS RESERVED.Trademarks are owned or controlled by the Canadian Real Estate Association (CREA) and identify real estate professionals who are members of CREA (REALTOR®, REALTORS®) and/or the quality of services they provide (MLS®, Multiple Listing Service®)
Listing information last updated on September 6th, 2025 at 6:47pm MDT